



## Advanced accessories

## Manual welding



## NEOPULSE 320 C

### Manual welding



NEOPULSE 320 C  
062474

optional extra

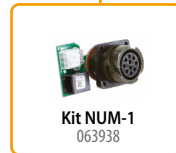

Kit NUM-1  
063938

OR



Connecting cable\*

RC-HD2  
062122

Remote control



Control circuit group\*

NEOFEED-4W  
014527

Wirefeeder N°2

optional extra



WCU 1KW C  
013537

Liquid  
052246



Trolley skate  
037717

optional extra



Trolley 10m³  
037328

## NEOPULSE 400 CW

### Manual welding



NEOPULSE 400 CW  
062061

optional extra



Kit NUM-1  
063938

OR



Connecting cable\*



RC-HD2  
062122

Remote control



Control circuit group\*



NEOFEED-4W  
014527

Wirefeeder N°2

# 1. CONFIGURATIONS - MIG

## NEOPULSE 400 G / 500 G



### Manual welding



NEOPULSE 400 G  
014497

NEOPULSE 500 G  
014503

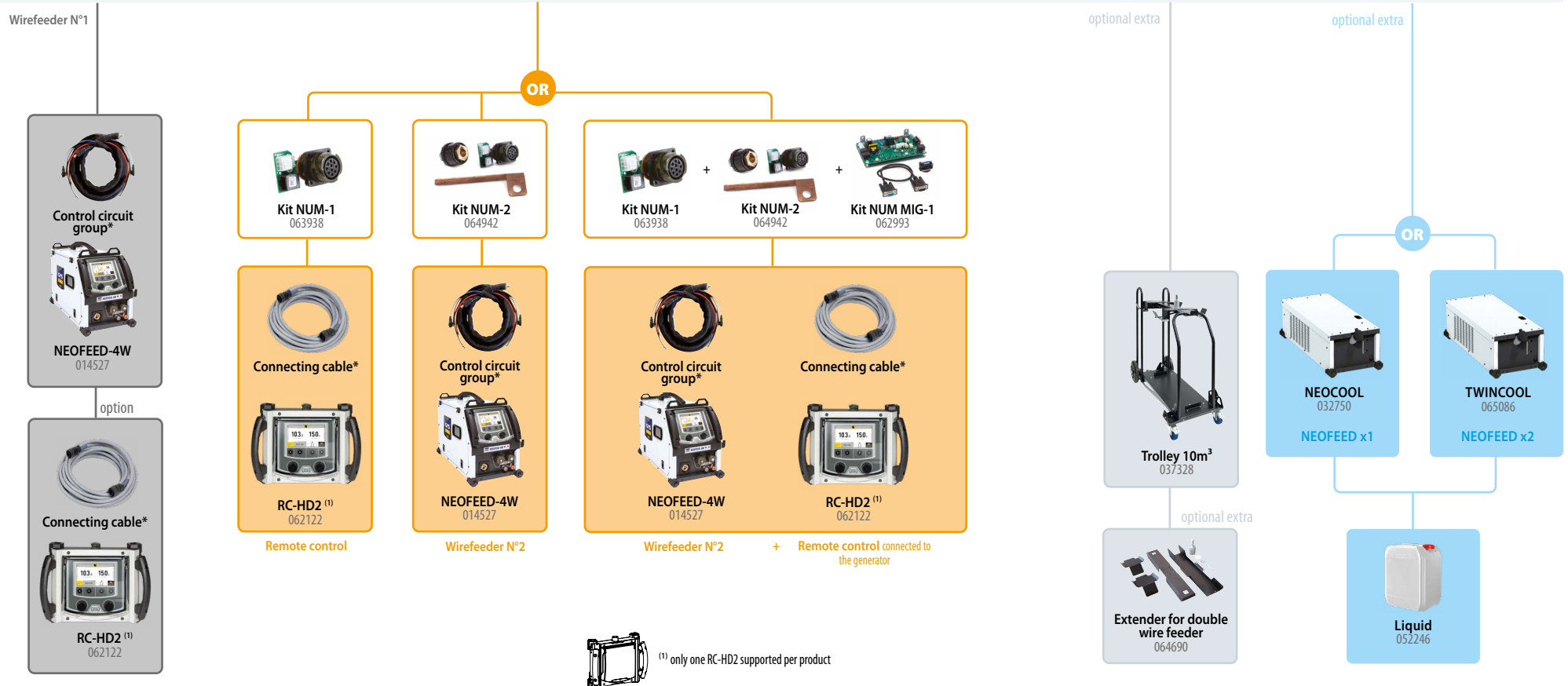

# 1. CONFIGURATIONS - TIG AC/DC



## TITANIUM 230 AC/DC



230  
VOLTS

1  
PHASE

**TITANIUM 230 AC/DC FV**  
061996

optional extra

optional extra



**Kit NUM-1**  
063938



**KOOLWELD 1**  
070820



**Liquid**  
052246



**Connecting cable\***



**RC-HD2**  
062122

\* see specifications on last page

## TITAN 231 DC FV



option

option



# 1. CONFIGURATIONS - PLASMA CUTTER



## CUTTER 45 CT

## CUTTER 70 CT



230  
VOLTS

1  
PHASE

CUTTER 45 CT  
014787



400  
VOLTS

3  
PHASES

CUTTER 70 CT  
013636

OR

OR



MT-70  
manual 75° torch\*



AT-70  
automatic torch\*



Kit CNC-1  
039988



Kit CNC-1  
039988



# 1. CONFIGURATIONS - PLASMA CUTTER



## NEOCUT 105 / 125

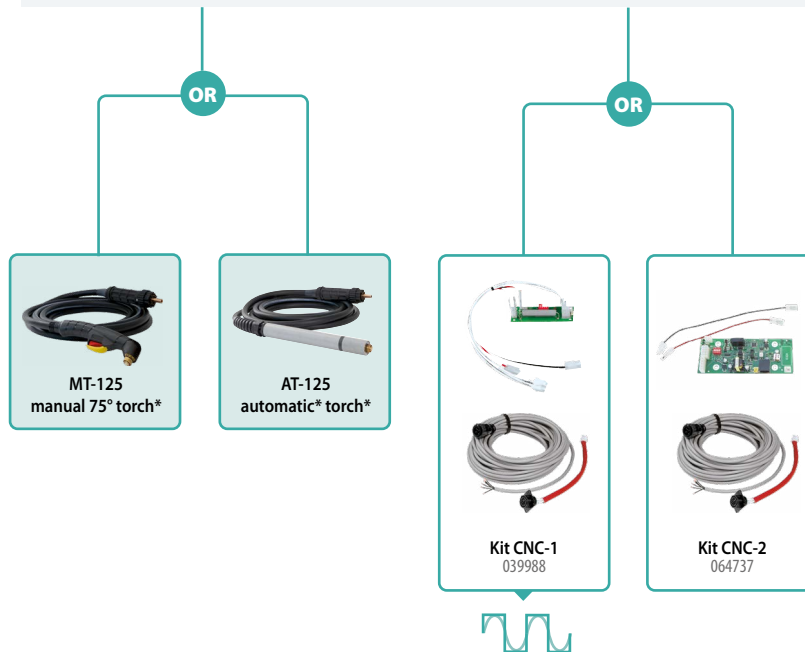



## 2. OPTIONAL EXTRAS & ACCESSORIES



### RC-HD2 connecting cable

<a href="#">063907</a>	2.8 m
<a href="#">063914</a>	6 m
<a href="#">036925</a>	11 m



### Control circuit group

<a href="#">071780</a>	Air - 1.8 m - Ø 70 mm <sup>2</sup>
<a href="#">047587</a>	Air - 5 m - Ø 70 mm <sup>2</sup>
<a href="#">047594</a>	Air - 10 m - Ø 70 mm <sup>2</sup>
<a href="#">047600</a>	Air - 10 m - Ø 95 mm <sup>2</sup>
<a href="#">038349</a>	Air - 15 m - Ø 95 mm <sup>2</sup>
<a href="#">038431</a>	Air - 20 m - Ø 95 mm <sup>2</sup>
<a href="#">037243</a>	Liquid - 1.8 m - Ø 70 mm <sup>2</sup>
<a href="#">047617</a>	Liquid - 5 m - Ø 70 mm <sup>2</sup>
<a href="#">047624</a>	Liquid - 10 m - Ø 70 mm <sup>2</sup>
<a href="#">047631</a>	Liquid - 10 m - Ø 95 mm <sup>2</sup>
<a href="#">038448</a>	Liquid - 15 m - Ø 95 mm <sup>2</sup>
<a href="#">038455</a>	Liquid - 20 m - Ø 95 mm <sup>2</sup>



### Handheld torch - Plasma Cutter

MT-70 (without consumables)	
<a href="#">037502</a>	6 m
<a href="#">037519</a>	12 m
MT-125 (without consumables)	
<a href="#">039506</a>	6 m
<a href="#">039513</a>	12 m



### Automatic torch - Plasma Cutter

AT-70 (without consumables)	
<a href="#">037526</a>	6 m
<a href="#">071865</a>	6 m (mini)
<a href="#">037533</a>	12 m
AT-125 (without consumables)	
<a href="#">038479</a>	6 m
<a href="#">039520</a>	12 m
<a href="#">069787</a>	15 m
<a href="#">069794</a>	20 m